

UH-1, AH-1 ...

Not Alike at All

It's a mistake to assume that all twins are identical.

The 42nd gearbox quill assembly on the Huey and Cobra look alike. And Items 1, 2, 3, 4, and 7 of Fig 89 of TM 55-1520-236-23P exactly match Items 1, 2, 3, 4, and 8 of Fig 182 in TM 55-1520-210-23P.

Cobra and Huey TM illustrations are almost identical

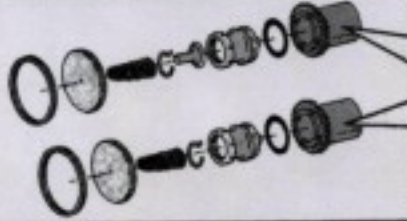

However, spline count is not



But the next parts in line—Item 8 for the Cobra and Item 11 for the Huey—are different. That difference could lead to disaster.

It's not easy to spot. Both fit into the same driveshaft coupling. The difference is inside. Item 8, the Cobra's spur gear, NSN 3020-00-439-5590, has 26 splines. Item 11, the Huey's spherical coupling, NSN 1615-00-791-6073, has 24.

Force the wrong one on a gearshaft and your helicopter and its crew will be in a world of hurt.

